

Maison Saint-Germain-en-Laye 245 m²



SALE PRICE : 1 349 000 €

EMAIL : CBAI@COLDWELLBANKER.FR

DESCRIPTION

Located in the Fourqueux district of Saint-Germain-en-Laye, close to the golf course, a 1.4 km from Mareil-Marly train station and 3 km from the RER A station. In Saint-Germain-en-Laye, several steps from the bus stop, local shops, and schools, this spacious house in good condition was built in 1998. It sits amidst a beautiful landscaped garden of over 1,000 m². This spacious, quiet house offers a triple reception room with a fireplace, 7 bedrooms, 3 bathrooms, a full basement, a double garage, two outdoor parking spaces, and a swimming pool renovated this year. Very well maintained and energy-efficient (DPE C), it is air-conditioned with a heat pump in addition to a gas boiler. The building's technical diagnostics meet current standards. Please contact us for further information or to arrange a viewing.

Selling price: €1,349,000 (including seller's fees)

Energy consumption: C

Information on the risks to which this property is exposed is available on the Géorisques website:

www.georisques.gouv.fr

Coldwell Banker Alcapa Invest - SIREN 793 427 386

Real estate agent - EI - Versailles RSAC No. 811 782 754

FEATURES

Property type:	Maison	Area:	245.0 m ²	Property tax:	€2.00
Number of rooms:	10 rooms	Number of bedrooms:	7 bedrooms		

Les informations sur les risques auxquels ce bien est exposé sont disponibles sur le site Géorisques : www.georisques.gouv.fr

ENERGY PERFORMANCE DIAGNOSIS

Energy performance diagnosis (EPD): C 160

Greenhouse gas emissions (GHG) index: C 27



COLDWELL BANKER
EUROPA REALTY



Ground Floor

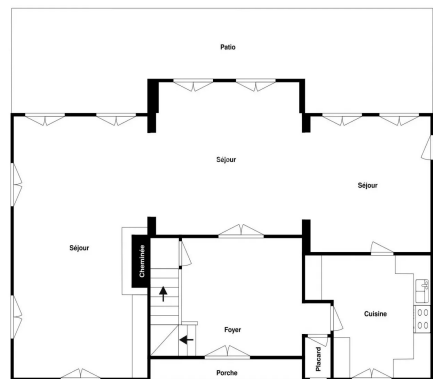

176 Avenue Charles de Gaulle
France, 92200, Neuilly-sur-Seine



PHONE : +33147220345
cbai@coldwellbanker.fr